

BOONE

AERATION & ENVIRONMENTAL CORP.



The FSD series of pulse jet filters are an economical and popular choice. The filter media is cleaned by short pulses of compressed air controlled by a programmable solid state timer. The side door removal of filter media allows the FSD to be installed in areas with limited headroom. Applications include wood chip and sawdust, agricultural products, chemicals, cement, and rock crushing.





OPTIONAL

- Support legs
- Catwalk and access ladder
- Explosion relief panel(s)
- Hi level indicator
- Photohelic gauge 0-10" S.P.W.G.
- Special filter bag materials
- Stainless steel construction
- Special paints or coatings

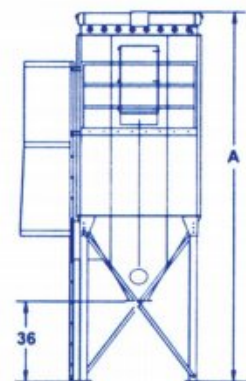
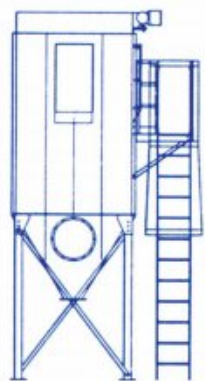
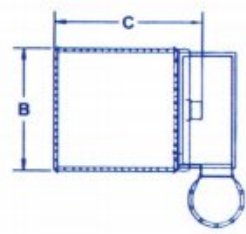

STANDARD SPECIFICATIONS

- 12 ga. carbon steel construction
- 17" W.G. rated
- 120 V timer board in Nema 4 enclosure
- Goyen diaphragm valves
- Compressed air header with drain
- Magnehelic gauge 0-10" S.P.W.G.
- Flanged inlet, outlet, and body
- High performance bag venturis
- Galvanized bag cages
- 16 oz. singed polyester filter bags
- Stainless steel bag clamps
- 60" hopper w/1.25 NPT coupling for high level indicator
- Hopper access panel
- Easy Lift lifting ears
- Standard metal preparation
- Primed and painted industrial white enamel

MODEL	CLOTH AREA	A	B	C	WT (LBS)
9-FSD-4	60	120	30	44	755
9-FSD-6	90	144	30	44	877
9-FSD-8	120	168	30	44	998
16-FSD-4	107	127	38	52	998
16-FSD-6	160	151	38	52	1171
16-FSD-8	213	175	38	52	1345
25-FSD-4	167	134	46	60	1233
25-FSD-6	250	158	46	60	1449
25-FSD-8	333	182	46	60	1664
36-FSD-4	240	141	54	68	1518
36-FSD-6	360	165	54	68	1794
36-FSD-8	480	189	54	68	2070
49-FSD-4	327	148	62	75	1798

MODEL	CLOTH AREA	A	B	C	WT (LBS)
49-FSD-6	490	172	62	75	2124
49-FSD-8	653	196	62	75	2450
64-FSD-4	427	155	70	84	2133
64-FSD-6	640	179	70	84	2528
64-FSD-8	853	203	70	84	2922
81-FSD-8	1080	222	82	96	4294
81-FSD-10	1350	246	82	96	4807
81-FSD-12	1620	270	82	96	5320
100-FSD-8	1333	229	90	105	4831
100-FSD-10	1667	253	90	105	5407
100-FSD-12	2000	277	90	105	5983
121-FSD-8	1613	237	98	113	5494
121-FSD-10	2017	261	98	113	6157

MODEL	CLOTH AREA	A	B	C	WT (LBS)
121-FSD-12	2420	285	98	113	6820
144-FSD-8	1920	244	106	122	6107
144-FSD-10	2400	268	106	122	6841
144-FSD-12	2880	292	106	122	7574
169-FSD-8	2253	251	114	130	7251
169-FSD-10	2817	275	114	130	8080
169-FSD-12	3380	299	114	130	8910
196-FSD-8	2613	258	122	138	7966
196-FSD-10	3267	282	122	138	8875
196-FSD-12	3920	306	122	138	9783
225-FSD-8	3000	265	130	146	8788
225-FSD-10	3750	289	130	146	9800
225-FSD-12	4500	313	130	146	10813

NOT FOR CONSTRUCTION

Boone Aeration & Environmental Corp.
 P.O. Box 369 ~ 1773 219th Lane ~ Boone, IA 50036 USA
 (515) 432-2010 ~ (800) 265-2010 ~ FAX (515) 432-5262